

Yungtay Elevator

Hitachi Yungtay Elevator Co., Ltd.

<https://en.hitachi-yungtay.com.tw>

Headquarter +886 2 2717-2217
11F., No. 99, Fuxing N. Rd., Songshan Dist., Taipei City 105, Taiwan (R.O.C.)

Taoyuan Plant +886 3 325-4161
No. 1352, Chunri Rd., Taoyuan Dist., Taoyuan City 330, Taiwan (R.O.C.)

Building System Branch +886 2 2709-3355
No. 6, Aly. 54, Ln. 63, Sec. 2, Dunhua S. Rd., Da'an Dist., Taipei City 106, Taiwan (R.O.C.)

Taoyuan Branch +886 3 317-1879
No. 29, Ln. 1314, Chunri Rd., Taoyuan Dist., Taoyuan City 330, Taiwan (R.O.C.)

Taichung Branch +886 4 2472-7878
3F., No. 98, Sec. 2, Dongxing Rd., Nantun Dist., Taichung City 408, Taiwan (R.O.C.)

Tainan Branch +886 6 303-8600
No. 18, Dongqiao 1st Rd., Yongkang Dist., Tainan City 710, Taiwan (R.O.C.)

Kaohsiung Branch +886 7 761-5161
No. 200, Dashun 3rd Rd., Lingya Dist., Kaohsiung City 802, Taiwan (R.O.C.)

Service Center +886 2 2701-7060
No. 6, Aly. 54, Ln. 63, Sec. 2, Dunhua S. Rd., Da'an Dist., Taipei City 106, Taiwan (R.O.C.)



VDI 4707



ISO 9001



ISO 14001



ISO 45001

TEL / +886 2 2717-2217
FAX / +886 2 2718-6082

Catalog No.YT-EL-0181 2022.12

Our Company reserves the rights to change the specifications, please be reminded that the information in regard with those changes shall not be notified later. Please contact our Company for further details.



GET THE COSY LIFE

MRL Residential Elevator - 8 Passenger



A pioneer leader in line with the new evolution of the spirit of environmental protection, Hitachi Yungtay Elevator will bring you higher-quality life and a future.

Quality

Higher Quality
Texture

Humanity

More Considerate
Human Interface

Energy Saving

More environment-friendly
space design

- 3 Car Design
- 7 Entrance Design
- 8 Handrail
- 9 Operating Panel
- 10 Functions and Equipment
- 12 Dimensions of Entrance
- 13 Hoistway Layout

Elevate Your Quality of Life



Car Design



European Classic

Silent Steady · Eternal Nobility

CH12

Model	CH12	
Ceiling	Steel Plate with Baked Painting (1-51)	
	Matching with Milky White Acrylic Plate	
	LED Lighting	
Operating Panel	Embedded Stainless Steel with Mirror Finish	
	Model: KF-D2FT (Patent Certificate Utility Model No. M420525)	
	Minimum Width of Front Wall	250mm
Car Door	Steel Plate with Colored Pattern (A111)	
Front Wall	Steel Plate with Colored Pattern (SNW-9)	
Side Wall	Steel Plate with Colored Pattern Left / Right Plate : (SNW-9) Middle Plate : (A111)	
Rare Wall	Steel Plate with Colored Pattern Left / Right Plate : (SNW-9) Middle Plate : (A111)	
	Mirror Plate Stainless Steel Decorative Strip	
Kickplate	(SUS) Stainless Steel Plate	
Floor	Faux Stone Floor Tile : (2103) Frame : (APG922)	



Classic Magnificence

The Poetry of Space, Forge of Texture

UH1

Model	UH1	
Ceiling	Steel Plate with Baked Painting (1-51)	
	Matching with Milky White Acrylic Plate	
	LED Lighting	
Operating Panel	Embedded Stainless Steel with Mirror Finish	
	Model: KF-D3FT (Patent Certificate Utility Model No. M420525)	
	Minimum Width of Front Wall	250mm
Car Door	Steel Plate with Colored Pattern (A111)	
Front Wall	Steel Plate with Colored Pattern (B103)	
Side Wall	Steel Plate with Colored Pattern Left / Right Plate and Waist Area : (B103) Middle Plate : (A111)	
Rare Wall	Steel Plate with Colored Pattern Left / Right Plate and Waist Area : (B103) Middle Plate : (A111)	
Kickplate	(SUS) Stainless Steel Plate	
Floor	NPC Floor Tile (536) + Frame (505)	





Car Design



Pure and Fresh Minimalism

Streamline of Fashion, Grace of Brightness



CH17

Model	CH17	
Ceiling	Steel Plate with Baked Painting (1N)	
	Convace Area (K030A)	
	LED Lighting	
Operating Panel	Embedded Stainless Steel with Mirror Finish	
	Model: KF-D2FT (Patent Certificate Utility Model No. M420525)	
	Minimum Width of Front Wall	250mm
Car Door	Steel Plate with Colored Pattern (1072)	
Front Wall	Steel Plate with Colored Pattern (1072)	
Side Wall	Steel Plate with Colored Pattern Left / Right Plate : (1072) Middle Plate : (1072)	
Rare Wall	Steel Plate with Colored Pattern Left / Right Plate : (1072) Decorative Line : (A101)	
Kickplate	Steel Plate with Colored Pattern (A101)	
Floor	NPC Floor Tile (505) Frame : (501)	



Delicate Paragon

Steady Magnitude · Prime Honor



CH18

Model	CH18	
Ceiling	Steel Plate with Colored Pattern (SNW-1)	
	Matching with Milky White Acrylic Plate	
	LED Lighting	
Operating Panel	Embedded Stainless Steel with Mirror Finish	
	Model: KF-D3FT (Patent Certificate Utility Model No. M420525)	
	Minimum Width of Front Wall	250mm
Car Door	Steel Plate with Colored Pattern (SNW-1)	
Front Wall	Steel Plate with Colored Pattern (SNA-7)	
Side Wall	Steel Plate with Colored Pattern Left / Right Plate : (SNA-7) Middle Plate : (SNW-1)	
Rare Wall	Steel Plate with Colored Pattern Left / Right Plate : (SNA-7) Middle Plate : (SNW-1)	
	Mirror Plate Stainless Steel Decorative Strip	
Kickplate	(SUS) Stainless Steel Plate	
Floor	NPC Floor Tile (531) + Frame (536)	



Entrance Design



Door Panel	Center - opening Doors
	Stainless Steel with Hairline Finish (Option)
Jamb Frame	Wide Type (Option)
	Stainless Steel with Hairline Finish
Sill	Extruded Hard Aluminum



Door Panel	Center - opening Doors
	Steel Plate with Baked Painting (1-60)
Jamb Frame	Narrow-Vertical Type
	Stainless Steel with Hairline Finish
Sill	Extruded Hard Aluminum

*Control Panel Location: The standard configuration is located at the broadside of the top floor entrance.



Door Panel	Center - opening Doors
	Steel Plate with Baked Painting (1-25)
Jamb Frame	Narrow Type
	Stainless Steel with Hairline Finish
Sill	Extruded Hard Aluminum



Handrail OPTION



NR-6
Mirror Finished Stainless Steel
Diameter : 38mm Φ



NR-108
Stainless Steel inlaid with Solid Wood (imitation walnut)
Diameter : 38mm Φ
Optional for Antibacterial Material



NR-112
Stainless Steel inlaid with Solid Wood (imitation sen)
Diameter : 38mm Φ
Optional for Antibacterial Material



NR-113
Stainless Steel inlaid with Hairline Stainless Steel
Diameter : 38mm Φ



NR-125
Stainless Steel inlaid with Genuine Leather
Diameter : 38mm Φ

*This catalog is only for reference; any modifications shall not be additionally informed, and the specifications still depend on the actual conditions.



Operating Panel



OPY-HD2T
Rotational Operating Panel
(hidden interphone attached)



FOX LED



FOX LED
(For Wheelchair Use)

OPTION



HF-LM5
OPTION



VF-LM5
OPTION



W.FOX OPB
(For Wheelchair Use)
OPTION

*This catalog is only for reference; any modifications shall not be additionally informed, and the specifications still depend on the actual conditions.



Functions and Equipment

Operating Functions

○ Standard △ Option

Overload Protection Function	The load inspection apparatus installed on the bottom of the elevator car will send a warning and cannot be operated whenever overload is detected.	○
Energy Saving Function	The car lighting and fans will stop running to save energy when the car is vacant for a while and will restart running if there is any calling from other floors.	○
Low-Speed Safe Landing while Malfunction	If the car has stopped between floors due to equipment malfunction, the car will automatically move to the nearest floor at low speed and open the door. Meanwhile, the elevator will stop service when the car is vacant.	○
Emergency Lighting	In the event of power failure, the emergency lighting installed on the car ceiling will automatically ignite.	○
Overspeed Protection	The elevator will automatically cut off the power source if the car exceeds the specified speed.	○
Overload Return Safety Device (ORS)	If an external force interferes during the door closing/opening, and this force exceeds the specified threshold, the elevator door will move in the reverse direction to ensure safety.	○
Car Call Cancellation	Deregister a mistaken floor by pressing the same floor button twice within 3 seconds	○
Next Floor Landing Function	When the car arrives on the floor but cannot fully open the door for any reason, such as object blocking, the car will travel to the next floor and automatically open the door. Also, when the car cannot successfully close the door due to the object stuck in the sill, the door will automatically open repeatedly until the object is removed.	○
Car Call Cancellation at Reversal	When the elevator changes direction, the system will cancel the previously registered floor, which can avoid invalid stops and save electricity	○
Out-of-Service Operation	For building management needs such as nights and holidays, the elevator needs to be parked; or when the elevator demand is low, the elevator is called back to the parked floor and stopped to save energy.	△
Mechanical Safety Shoe	During the door-closing process of the elevator, when the door safety shoe collides with a person or item, the elevator will stop closing and reopen the door immediately.	△

Signal and Display

Arrival Lighting in Hall (floor indicator blinking)	As the elevator travels, the directional arrows begin to flow. When the building name flashes, the elevator is about to arrive. During running: the running direction arrow moves with the running direction of the elevator. Before arrival: the button and the floor number flash.	○
Arrival Lighting in Car (landing floor button blinks)	The floor button in the car will flash to notify passengers in the car that the elevator is about to arrive. During running: the running direction arrow moves with the running direction of the elevator. Before Arrival: The button and the name of the building flash.	○
Interphone System	When an emergency occurs in the car, press the emergency call button for more than 3 seconds, and the system will dial the preset outside line to ask for help. (six groups of phone numbers can be preset)	○
Intercom	In the event of an emergency, press the emergency button to communicate with the administrator.	○
Intercom Central Management	A community group can connect a direct line to the administrative room for the central management to rescue personnel in case of an emergency.	△



Functions and Equipment

Comfort and Convenience

Infrared Light Curtain	The elevator will promptly detect any people or objects blocking the infrared light curtain and reopen the door during the closing process, improving passengers' safety.	○
Extended Door Opening Time Button	Pressing the door opening button can extend the elevator door opening hold time.	△

Special Operating Function

Automatic Landing Device for Power Failure (ALP)	In the event of a power failure, the device will replace the regular power supply, and the elevator will automatically move to the nearest floor to allow passengers to exit the car safely, thereby avoiding the situation where passengers are locked in the elevator during a power failure	○
Earthquake Emergency Operation	When the earthquake sensor is activated, the running elevator will automatically run to the nearest step and stop service. Simultaneously, "Earthquake Control" will be displayed in the operation panel.	△
Fire Emergency Operation	When a fire occurs, the elevator will automatically run to the preset fire escape floor through the fire switch and then stop	△

Monitor and Supervision Function

Monitoring and Control System (CCTV)	Through this device, the superintendent of the building can observe the situation in the elevator car to prevent the occurrence of crimes.	△
Card Reader Interface	Provide contact points for card reader machines in elevator halls or cars, reserve holes in the inner wall panels of the car, and assist in the installation of card reader machines so cardholders can use the elevator.	△
Remote Surveillance	The remote surveillance system is the tech product of YUNATAY to serve our customers 24 hours a day. Through the advanced telecom network as well as the global elevator connection, we can grasp the safety conditions of our customers' elevators in real-time, making the passengers safer and the maintenance more efficient.	△
Central Control and Monitoring System (YECM)	The YECM system transmits the elevator operation signal in the operation panel to the monitoring computer through digital communication. The administrator can monitor the running status of the elevator, set the running mode, issue control commands, perform statistical analysis of the elevator operation, make reservations, and record the faults of the elevator.	△
Supervisory Panel	The device consists of a display part for monitoring the running status of the elevator, an operation part for elevator operations, and an intercom for communication with the car.	△

Passenger	8 persons (550KG)	Maximum Landing Floor	8	Power Supply	AC 3Φ 220V	AC 1Φ 220V
Rated Speed	45m/min, 60m/min	Maximum Travel Height	26m	Motor Capacity	6KVA	7KVA
Entrance Dimensions	800mm(W)x2100mm(H)	Control Method	AC-VF	Breaker	50A	60A
Car Interior Dimensions	1100mm(W)x1310mm(D)	Lighting Supply	AC1Φ 110V	Wire Gauge	8mm ²	14mm ²
Hoistway Dimensions	1900mm(W)x1700mm(D)	Motor 45m/min	4.0kw	Ground Wire	5.5mm ²	
Minimum Floor Height	2600mm	Motor 60m/min	5.5kw			

*The single-phase electric power is only suitable for 45m/min house single-family or seven households (including) on the 8th floor of a single building.
 *The ones with reduced mobility only apply to pure collective housing, not for public use.



Dimensions of Entrance

Narrow Type

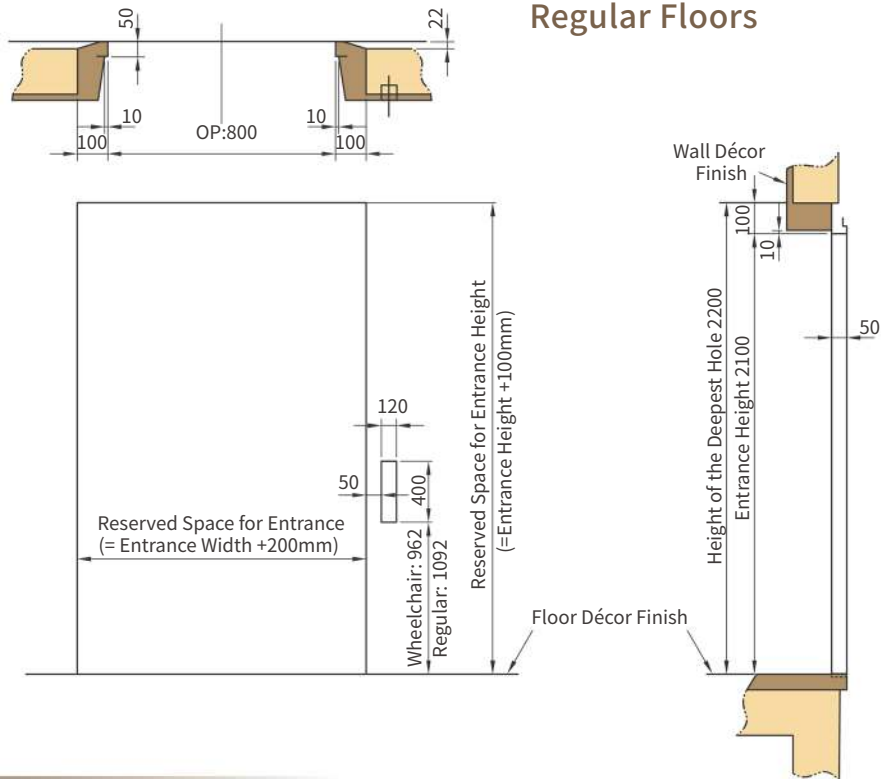

Wide Type

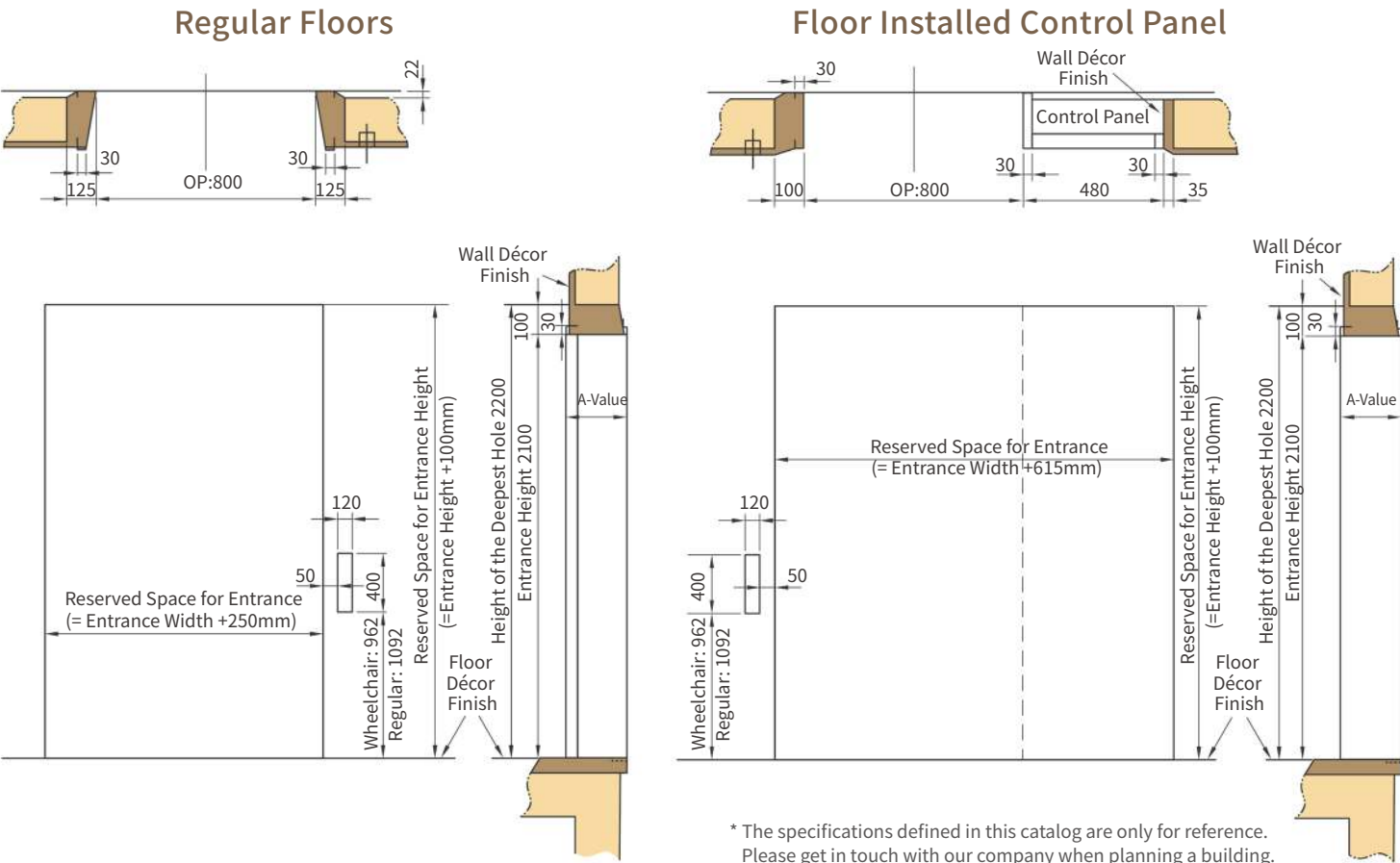

* The specifications defined in this catalog are only for reference.
 Please get in touch with our company when planning a building.



Hoistway Layout

Hoistway Section

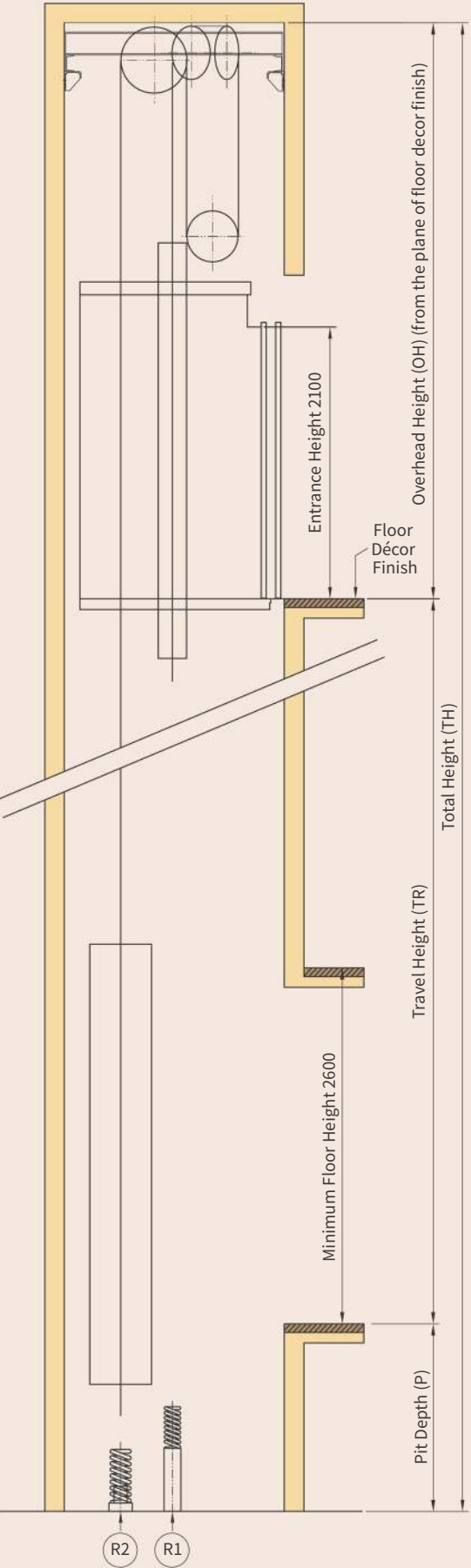

Hoistway Floor Plan

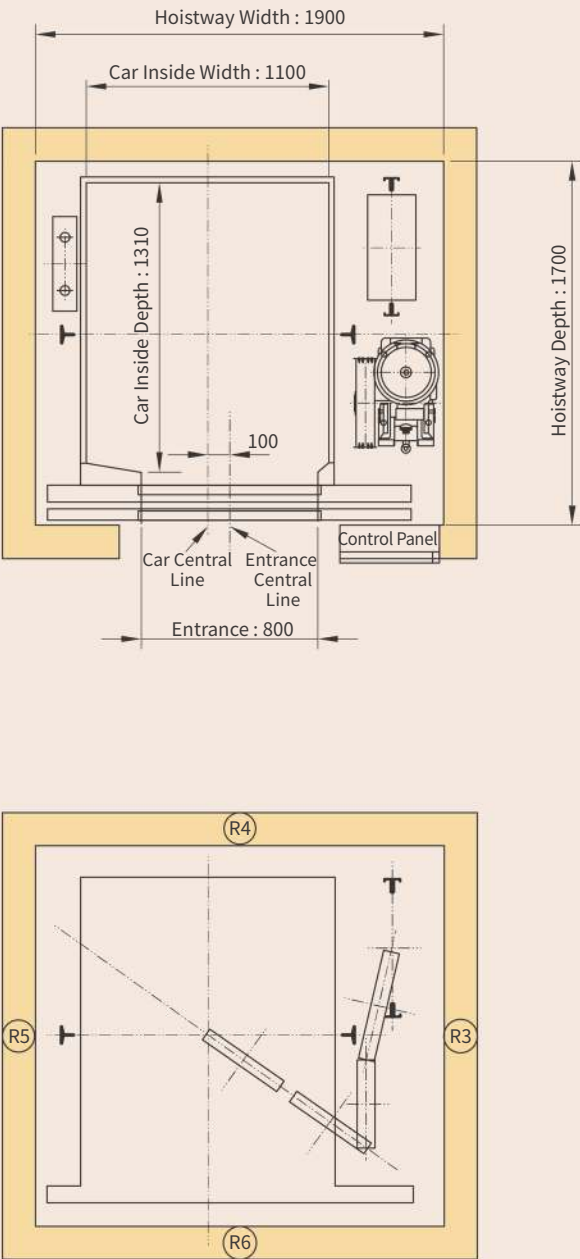

Unit : mm

Position	R1	R2	R3	R4	R5	R6	備註
Reaction Loading(KG)	6000	4800	4500	3200	2200	2200	(行程26M以下)

Item	Rated Speed	45	60
Overhead Height (OH)(mm)		4450	4650
Pit Depth (P)(mm)		1350	1550

* The specifications defined in this catalog are only for reference.
Please get in touch with our company when planning a building.



Excluded Constructions

Our company is responsible for the elevator's design, manufacture, and installation. However, the items mentioned above are not included in the elevator estimate. Therefore, the client should be responsible for entrusting the construction or electrical engineering contractor to carry out the project.

1. The construction of the hoistway is based on the drawings provided by Party B. It includes the entrances and exits of each floor, the preserve holes for buttons and indicators, and the caulking of the door frame after installation.
2. If the hoistway is of steel structure or light partition wall, support beams and columns for fixing guide rails, door frames, buttons, indicators, and other equipment; and primary iron parts for intermediate beams and reinforcing beams.
3. Piping and wiring work for emergency telephones or other equipment (such as monitors, remote monitoring systems, monitoring panels, multimedia, card reader machines and fire alarm switchboards) from the hoistway to the guard room (or administrator room, monitoring room).
4. Suppose the elevator entrance and exit doors have fire prevention functions. In that case, the piping and wiring work from the fire alarm reception switchboard to the elevator recall button to the evacuation level, and reserve a no-voltage A contact on the fire alarm reception switchboard.
5. Waterproof and drainage work for pits and concrete foundation works for buffers.
6. Primary side power supply equipment (including power supply, car lighting power supply, independent grounding system, switch, and the power receiving panel) and the piping and wiring project of leading the power supply to the hoistway.
7. Before the elevator enters the site for construction, the surrounding of the hoistway should be truly closed, and party B should install related guardrail protection equipment at the entrances and exits of each floor. If the hoistway is a glass curtain or cannot be reliably closed due to other factors, party B should provide other anti-fall measures (such as guardrails, safety nets, and other anti-fall measures). Party B must clear sundries such as formwork, wooden strips, safety nets, and steel bars in the machine room and the hoistway (if this item is not completed, due to the safety of the operation, personnel will not be dispatched to the site for construction).
8. After the machine parts are delivered to the construction site, party B should provide a storage place for the goods and tools. However, if the installation cannot be performed due to the reasons of Party A, the responsibility for keeping the machine parts shall be responsible to Party A.
9. After unpacking and installing the goods, Party B shall dispose of them at the designated place. Party A shall be responsible for clearing and transporting them to the construction site.
10. Party B shall provide the cement, sand and gravel, water, and electricity required in the construction and the power supply for installation and operation consistent with the official electricity consumption.
11. Party B shall provide the height reference line of the elevator entrance and exit and the complete reference line of the elevator wall as the basis for the elevator installation.
12. Construction of middle beam between two abreast elevators, over-widened hoistway, or installing broadside (rear) beam of the brick wall.
13. Installation of fall prevention facility of hoistway entrance before elevator installation.